



**RANDALL  
PAULSON**  
architects

Roswell • Nashua

FLORIDA REG. # AA0003296



10-13-2023  
Roswell Mill  
85-A Mill Street, Suite 200  
Roswell, Georgia 30075  
770.650.7558  
www.randallpaulson.com

architecture/interiors

These plans and specifications are the property of Randall Paulson Architects, Incorporated. These documents may not be copied, reproduced, used or implemented in any way, in part or in whole, without the written consent of Randall Paulson Architects, Incorporated. All common law rights of copyright are hereby specifically reserved.

**BUILDING 4**  
**SPECULATIVE WAREHOUSE**  
at  
**LEGEND POINT**

for  
**SCANNELL PROPERTIES**  
ST. JOHNS, FLORIDA

PHILLIPS HWY N.  
(US HWY 1 N.)

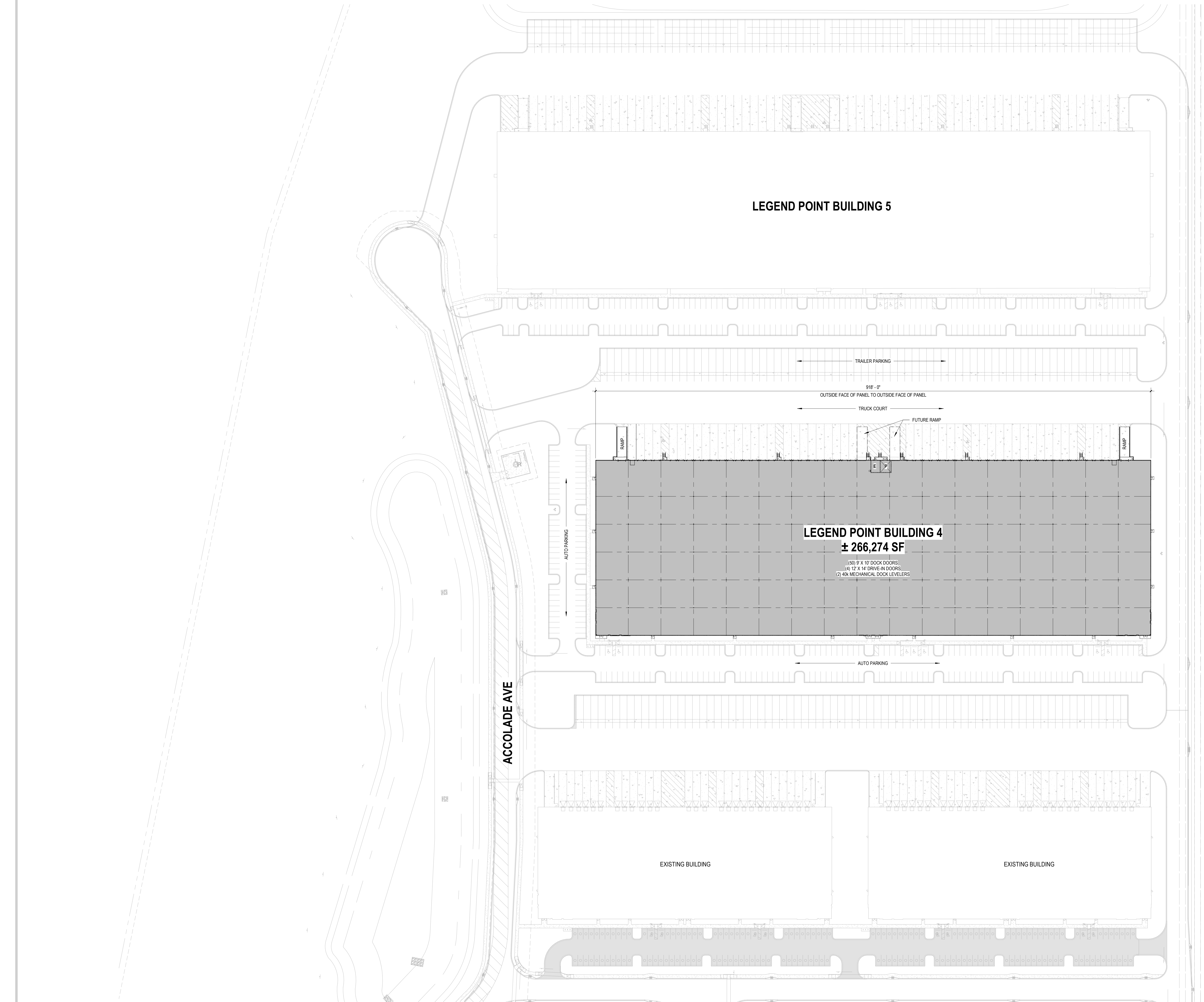

1 OVERALL SITE PLAN  
A-090 1" = 60'-0"

Drawn By: DR  
Checked By: BP

Print Record	
06 JULY 2022	PRICING SET
13 OCT. 2023	55% PERMIT SET

Revisions	

Date: 13 OCTOBER 2023 Project No.: 2022289.00  
Sheet Title: ARCHITECTURAL SITE PLAN

Sheet No.: **A-090**  
 Released for Construction  
 Not Released for Construction



**RANDALL  
PAULSON**  
architects  
Roswell • Nashua

FLORIDA REG. # AA0003296

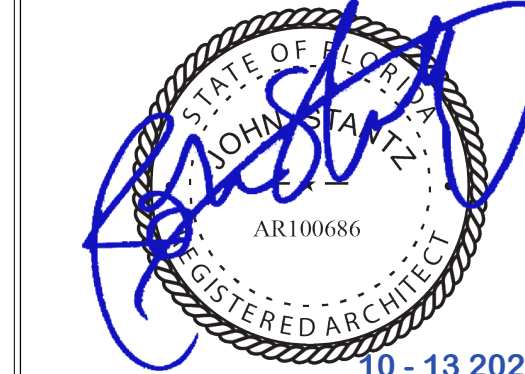

10-13-2023  
Roswell Mill  
85-A Mill Street, Suite 200  
Roswell, Georgia 30075  
770.650.7558  
www.randallpaulson.com

architecture/interiors

These plans and specifications are the property of Randall Paulson Architects, Incorporated. These documents may not be copied, reproduced, used or implemented in any way, in part or whole, without the written consent of Randall Paulson Architects, Incorporated. All common law rights of copyright are hereby specifically reserved.

**BUILDING 4  
SPECULATIVE  
WAREHOUSE**  
at  
**LEGEND POINT**

for  
**SCANNELL  
PROPERTIES**  
ST. JOHNS, FLORIDA

Drawn By: DR  
Checked By: BP

Print Record	
06 JULY 2022	PRICING SET
13 OCT. 2023	55% PERMIT SET

Revisions	

Column Line	B' JOIST (TYP.)	B' GIRDER (TYP.)
COLUMN LINE A	30' - 7 1/2"	N/A
COLUMN LINE B	32' - 1"	29' - 3 1/2"
COLUMN LINE C	33' - 0"	32' - 1"
COLUMN LINE D	33' - 11 1/2"	32' - 2 1/2"
COLUMN LINE E	34' - 11"	32' - 2 1/2"
COLUMN LINE F	35' - 10 1/2"	33' - 1 1/4"

Date: 13 OCTOBER 2023  
Project No.: 2022289.00  
Sheet Title: OVERALL BUILDING PLAN

Sheet No.: **A-100**  
Released for Construction  
Not Released for Construction

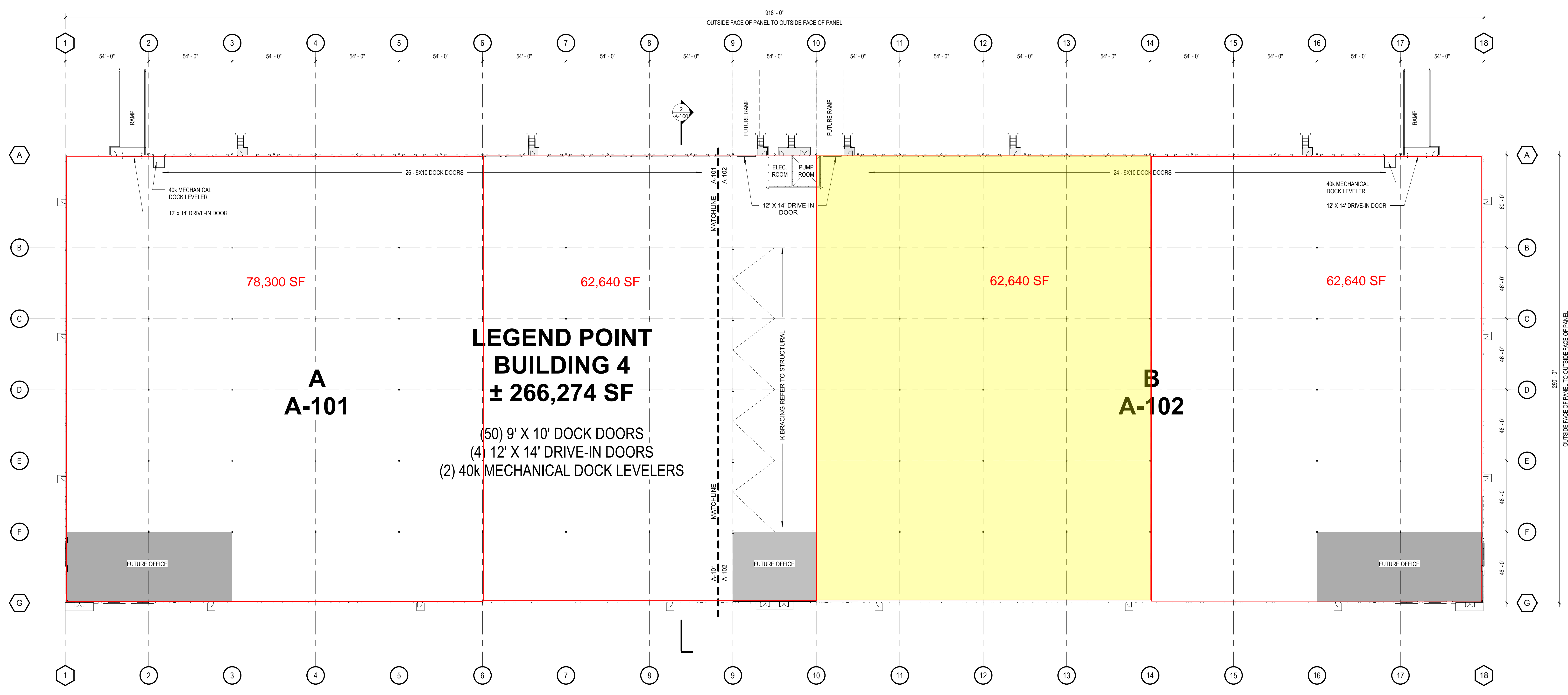

1 OVERALL FLOOR PLAN  
A-100 1" = 30'-0"

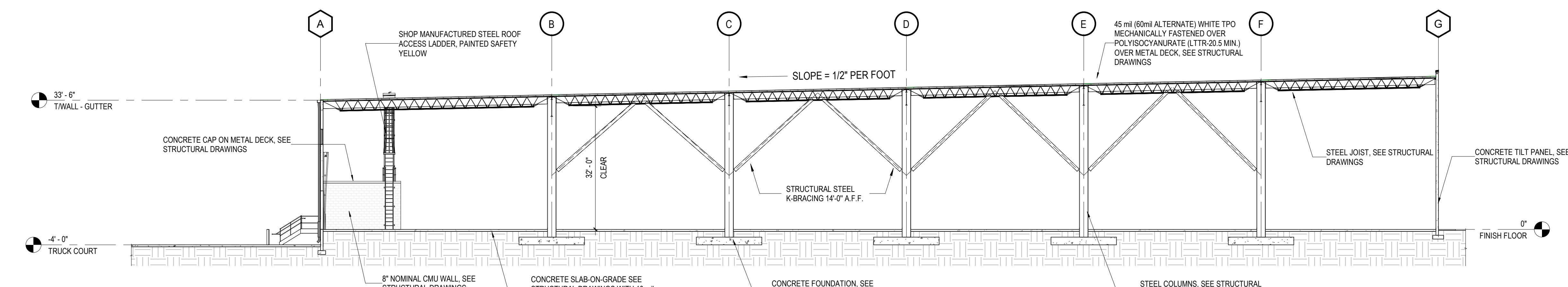

2 OVERALL BUILDING SECTION  
A-100 1/16" = 1'-0"

**CLEAR HEIGHT LEGEND**

Column Line	B' JOIST (TYP.)	B' GIRDER (TYP.)
COLUMN LINE A	30' - 7 1/2"	N/A
COLUMN LINE B	32' - 1"	29' - 3 1/2"
COLUMN LINE C	33' - 0"	32' - 1"
COLUMN LINE D	33' - 11 1/2"	32' - 2 1/2"
COLUMN LINE E	34' - 11"	32' - 2 1/2"
COLUMN LINE F	35' - 10 1/2"	33' - 1 1/4"

